

TIPPLER LAYOUT DETAIL (CONTINUED BELOW)
SCALE 1:500

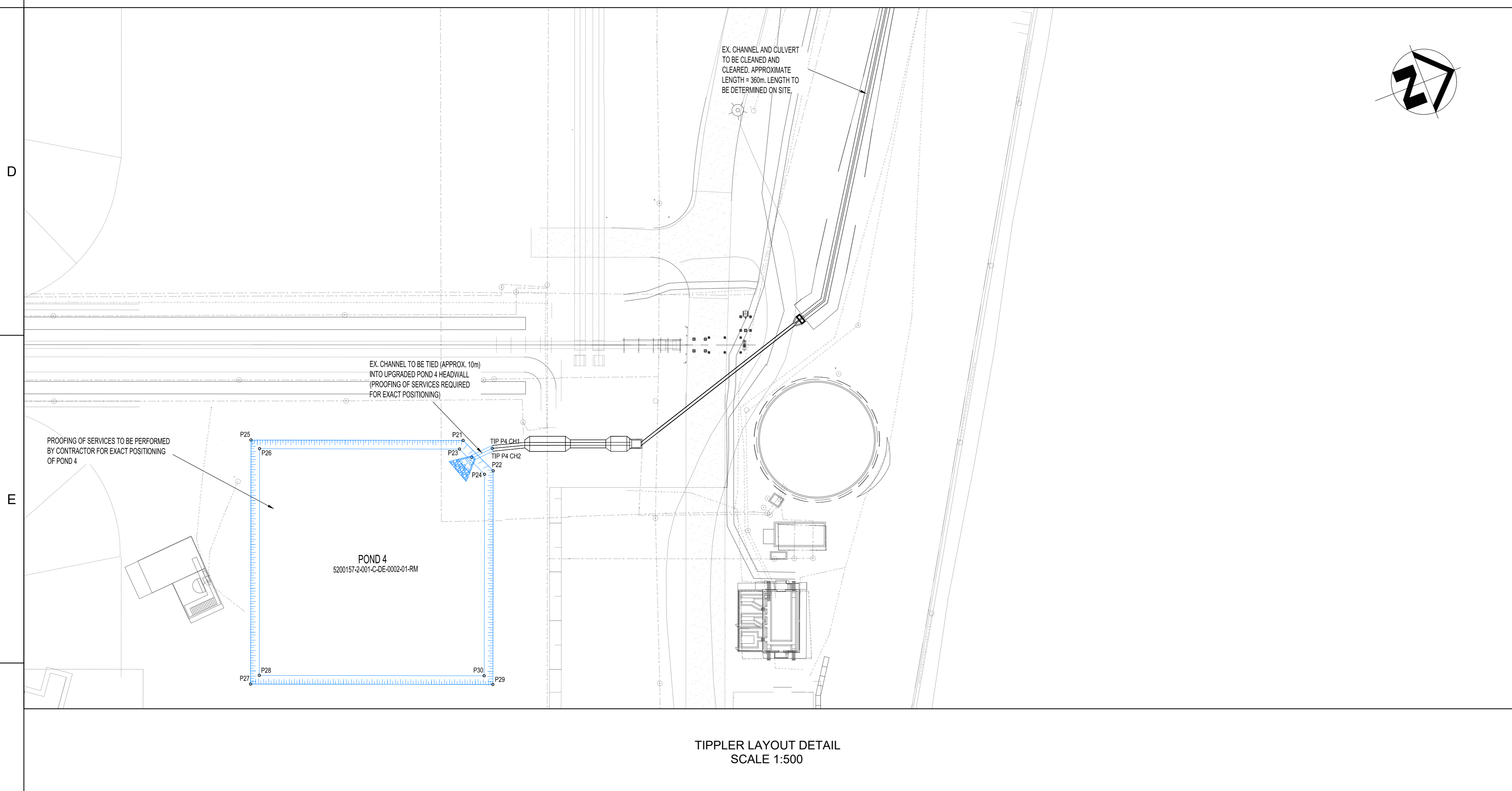

TIPPLER LAYOUT DETAIL
SCALE 1:500

5200157-2-001-C-LA-0002-01	TIPPLER - STORMWATER TIPPLER GENERAL LAYOUT AND KEY PLAN
5200157-2-001-C-LA-0002-02	TIPPLER - LAYOUT DETAIL SHEET 1 OF 3
5200157-2-001-C-LA-0002-03	TIPPLER - LAYOUT DETAIL SHEET 2 OF 3
5200157-2-001-C-LA-0002-04	TIPPLER - LAYOUT DETAIL SHEET 3 OF 3
5200157-2-001-C-SE-0002-01	TIPPLER - STORMWATER LONGSECTION SHEET 1 OF 3
5200157-2-001-C-SE-0002-02	TIPPLER - STORMWATER LONGSECTION SHEET 2 OF 3
5200157-2-001-C-SE-0002-03	TIPPLER - STORMWATER LONGSECTION SHEET 3 OF 3
5200157-2-001-C-DE-0002-01	TIPPLER - POND 1, POND 2 AND POND 4 CROSS-SECTION DETAIL
5200157-2-001-C-DE-0002-02	TYPICAL GRID CHANNEL, MOUNTABLE KERB, SUBSOL, COLLECTOR DRAIN (SCD) AND TRAPEZOIDAL CHANNEL DETAIL
5200157-2-002-C-DE-0002-03	TIPPLER - TYPICAL STORMWATER MANHOLE DETAILS SD4 AND SD5
DRAWING NO.	REFERENCE
REFERENCE DRAWINGS	
1	
2	
3	
4	
5	
6	
7	
8	

- NOTES
- MEASUREMENTS ARE BASED ON METRIC SYSTEM
 - ALL LEVELS ARE IN METERS TO MEAN SEA LEVELS (MSL)
 - DO NOT SCALE DRAWING - ONLY DIMENSIONS SHOWN TO BE USED
 - THE CONTRACTOR SHALL VERIFY ALL SERVICES OR CONDITIONS ON THE SITE AND NOTIFY THE ENGINEERING OF ANY VARIATIONS FROM DIMENSIONS BEFORE CONSTRUCTION

GENERAL NOTES:

- THE CONTRACTOR WILL BE DEEMED TO HAVE INSPECTED THE SITE AND BE IN AGREEMENT WITH THE WORKS REQUIRED AS PER THE TENDER DOCUMENTS, UNLESS ALTERNATIVE PROPOSALS WITH COST IMPLICATIONS ARE RECEIVED TOGETHER WITH THE TENDER DOCUMENTS. ALTERNATIVE PROPOSALS SUBMITTED DURING CONSTRUCTION SHALL BE ON A DESIGN AND CONSTRUCT BASIS, WITH THE DESIGN AT CONTRACTOR'S EXPENSE.
- VARIATIONS DEEMED NECESSARY BY THE CONTRACTOR SHALL BE FORWARDED TO THE PROJECT MANAGER IN WRITING FOR APPROVAL BEFORE ANY CONSTRUCTION, BASED ON THE VARIATION COMMENCES.
- SERVICES SHOWN ON DRAWING ARE KNOWN OR SOURCED FROM EXISTING DRAWINGS. THE CONTRACTOR MUST ENSURE THAT ALL SERVICES THAT INTERSECT OR RUN ALONGSIDE THE PROPOSED WORKS ARE LOCATED BEFORE CONSTRUCTION COMMENCES. ANY CLASHES SHALL BE REPORTED TO THE PROJECT MANAGER IN WRITING. THE CONTRACTOR SHALL BE HELD LIABLE FOR ANY DAMAGES TO EXISTING SERVICES DUE TO NEGLIGENCE.
- ALL EXISTING PIPES AND MANHOLES INCORPORATED INTO THE NEW SYSTEM SHALL HAVE DEFECTS RECTIFIED TO COMPLY TO STANDARDS FOR NEW WORKS.
- DIMENSIONS SHOWN ON DRAWINGS SHALL TAKE PREFERENCE OVER DIMENSIONS SCALED.
- ALL LEVELS AND DIMENSIONS SHALL BE CHECKED BEFORE ANY WORK COMMENCES. FAILURE TO DO SO SHALL BE THE CONTRACTOR'S RESPONSIBILITY FOR ANY WORK REQUIRED TO RECTIFY ERRORS AS A RESULT OF THE FAILURE TO CHECK THE LEVELS AND DIMENSIONS.
- ALL DIMENSIONS ARE IN MILLIMETERS AND LEVELS ARE IN METERS, UNLESS OTHERWISE INDICATED.
- THE LATEST REVISION OF SANIS SPECIFICATIONS SHALL APPLY. ALL WORK SHALL BE DONE IN ACCORDANCE WITH RELEVANT SANIS SPECIFICATIONS, UNLESS OTHERWISE INDICATED.
- ALL LENGTHS SHOWN ARE APPROXIMATE AND SHALL BE CONFIRMED ON SITE BY CONTRACTOR.

STORMWATER NOTES:

- TRENCHES FOR PIPES TO BE EXCAVATED AND BACKFILLED IN ACCORDANCE WITH THE REQUIREMENT OF SANIS 1001.08 - PIPE TRENCHES.
- ALL RIGID CONCRETE PIPES SHALL HAVE CLASS B BEDDING UNLESS STATED OTHERWISE.
- FOR STORMWATER PIPES SHALL BE SPIGOT & SOCKET CLASS 1000 (SANIS 67).
- ALL CONCRETE PIPE JOINTS TO BE WRAPPED WITH 142 BDM NONWOVEN CONTINUOUS FILAMENT NEEDLE PUNCHED POLYESTER GEOTEXTILE MIN. WIDTH TO BE 750mm FOR PIPES 300 TO 600.
- NB. ALL MANHOLE COVERS TO SUIT CROSSFALL OF FINISHED PAVING.
- ON COMPLETION, THE INSTALLATION SHALL BE TESTED TO THE ENGINEER'S SPECIFICATION.
- THE CONTRACTOR SHALL SUBMIT A FULL SET OF AS-BUILT DRAWINGS UPON COMPLETION OF THE INSTALLATION.
- ALL EXISTING STORMWATER PIPES, MANHOLES, CHANNELS AND ANY OTHER STORMWATER INFRASTRUCTURE TO BE CLEANED AND CLEARED OF ALL DEBRIS BEFORE ANY WORK COMMENCES. ALL DAMAGED EXISTING STORMWATER INFRASTRUCTURE SHALL BE REINSTATE TO ORIGINAL CONDITION.
- ANY DISCREPANCIES IN LEVELS AND SETTING OUT DATA TO BE QUERIED WITH THE ENGINEER PRIOR TO COMMENCEMENT OF ANY WORK.
- ALL EXISTING STORMWATER PIPES ARE CONCRETE UNLESS STATED OTHERWISE.
- WHERE MINIMUM COVER OF 1000mm FOR OPERATIONAL AREAS & 600mm FOR NON OPERATIONAL AREA CANNOT BE ACHIEVED, CONCRETE ENCASEMENT IS REQUIRED AS PER THE DETAIL DRAWINGS.

EARTHWORKS:

- ANY DISCREPANCIES IN LEVELS AND SETTING OUT DATA TO BE QUERIED WITH THE ENGINEER PRIOR TO COMMENCEMENT OF ANY WORK.
- ALL WORKMANSHIP TO BE IN ACCORDANCE WITH SANIS 1200 PART D - EARTHWORKS AND THE RELEVANT PROJECT SPECIFICATIONS AS INCLUDED IN THE CONTRACT.
- BEFORE PLACING ANY MATERIAL, THE EXISTING GROUND SURFACE MUST BE CLEARED AND GRUBBED OF ALL VEGETATION AND ORGANIC MATTER.
- UNLESS OTHERWISE INDICATED, ALL BANK BATTERS TO BE 1:1.5 CUT AND 1:2 FILL.
- THE UNCOMPLICATED THICKNESS OF FILL LAYERS SHALL NOT EXCEED 300mm.
- LOCATE ALL EXISTING SERVICES IN AREA PRIOR TO ANY CONSTRUCTION TAKING PLACE.
- THE CONTRACTOR IS TO TAKE DRAINAGE AND ENCOUNTERING BEDROCK INTO ACCOUNT IN ACCORDANCE TO THE TRUE NATURE AND EXTENT OF THE WORKS. SEE WORKS INFORMATION FOR MORE DETAIL.

CONSTRUCTION & REHABILITATION ACTIVITIES FOR STORMWATER SYSTEM:

- REMOVE ALL DUST & CAKED MATERIAL FROM SURFACE & SUB-SURFACE DRAINAGE SYSTEMS.
- REPAIR EROSION RUNNELS & RE-SHAPE ALL HARD STANDING AREAS TO ENSURE DRAINAGE TOWARDS THE DETENTION POND.
- PIPES, CULVERTS, MANHOLES & CHANNELS NEED TO BE CLEANED REGULARLY AS SYSTEM IS BLOCKED & MANHOLES ARE Silted UP.
- LENGTHS OF PIPES, NUMBER OF CULVERTS & MANHOLES CLEARLY SHOWN IN LONGITUDINAL SECTION FOR QUANTIFYING.
- CLEAN OUT ALL SLABS & DRYING BEDS.
- RE-SHAPE ALL HARD STANDING AREAS TO ENSURE DRAINAGE AWAY FROM THE ROADS TOWARDS THE STORMWATER POND.
- LOW POINTS TO BE REPAIRED WITH A MINIMUM OF 150 mm G2 LAYER COMPACTED TO 95 % MOD-AASHTO.

CONSTRUCTION & REHABILITATION ACTIVITIES FOR POND 1, POND 2 AND POND 4:

- FOR RESPECTIVE POND DETAIL REFER TO DRAWING 5200157-2-001-C-DE-0002-01.
- CLEAR ALL GRUB & VEGETATION.
- COMPACT TO 95% MOD-AASHTO.
- REPAIR & REINSTATE ALL DOWN CHUTES IF APPLICABLE.
- PLACE STONE PITCHING ENERGY DISSIPATORS AT OUTLET OF CULVERTS & DOWN CHUTES.
- DETENTION POND TO BE CONSTRUCTED TO NEW APPROVED LAYERWORKS.
- PLEASE SEE 5200157-2-001-C-DE-0002-01 FOR POND 1, POND 2 AND POND 4 LAYERWORKS.

TIPPLER SETTING OUT COORDINATES			
Position X	Position Y	COORDINATE ID	
-53734.58	-3653422.36	B01	-5363277.59
-53731.22	-3653420.57	B02	-5363274.07
-53727.85	-3653418.78	B03	-5363270.99
-53724.49	-3653416.99	B04	-5363274.21
-53721.13	-3653415.21	B05	-5363405.24
-53717.76	-3653413.42	B06	-5363417.04
-53714.40	-3653411.63	B07	-5363309.60
-53711.03	-3653409.84	B08	-5363307.60
-53707.67	-3653407.81	B09	-5363305.80
-53704.29	-3653405.82	B10	-5363303.80
-53700.92	-3653403.83	B11	-5363301.80
-53697.55	-3653401.82	B12	-5363299.80
-53694.18	-3653399.81	B13	-5363297.80
-53690.81	-3653397.80	B14	-5363295.80
-53687.44	-3653395.79	B15	-5363293.80
-53684.07	-3653393.78	B16	-5363291.80
-53680.70	-3653391.77	B17	-5363289.80
-53677.33	-3653390.00	B18	-5363287.80
-53673.96	-3653388.00	B19	-5363285.80
-53670.59	-3653386.00	B20	-5363283.80
-53667.22	-3653384.00	B21	-5363281.80
-53663.85	-3653382.00	B22	-5363279.80
-53660.48	-3653380.00	B23	-5363277.80
-53657.11	-3653378.00	B24	-5363275.80
-53653.74	-3653376.00	B25	-5363273.80
-53650.37	-3653374.00	B26	-5363271.80
-53647.00	-3653372.00	B27	-5363269.80
-53643.63	-3653370.00	B28	-5363267.80
-53640.26	-3653368.00	B29	-5363265.80
-53636.89	-3653366.00	B30	-5363263.80
-53633.52	-3653364.00	B31	-5363261.80
-53630.15	-3653362.00	B32	-5363259.80
-53626.78	-3653360.00	B33	-5363257.80
-53623.41	-3653358.00	B34	-5363255.80
-53620.04	-3653356.00	B35	-5363253.80
-53616.67	-3653354.00	B36	-5363251.80
-53613.30	-3653352.00	B37	-5363249.80
-53609.93	-3653350.00	B38	-5363247.80
-53606.56	-3653348.00	B39	-5363245.80
-53603.19	-3653346.00	B40	-5363243.80
-53599.82	-3653344.00	B41	-5363241.80
-53596.45	-3653342.00	B42	-5363239.80
-53593.08	-3653340.00	B43	-5363237.80
-53589.71	-3653338.00	B44	-5363235.80
-53586.34	-3653336.00	B45	-5363233.80
-53582.97	-3653334.00	B46	-5363231.80
-53579.60	-3653332.00	B47	-5363229.80
-53576.23	-3653330.00	B48	-5363227.80
-53572.86	-3653328.00	B49	-5363225.80
-53569.49	-3653326.00	B50	-5363223.80
-53566.12	-3653324.00	B51	-5363221.80
-53562.75	-3653322.00	B52	-5363219.80
-53559.38	-3653320.00	B53	-5363217.80
-53556.01	-3653318.00	B54	-5363215.80
-53552.64	-3653316.00	B55	-5363213.80
-53549.27	-3653314.00	B56	-5363211.80
-53545.90	-3653312.00	B57	-5363209.80
-53542.53	-3653310.00	B58	-5363207.80
-53539.16	-3653308.00	B59	-5363205.80
-53535.79	-3653306.00	B60	-5363203.80
-53532.42	-3653304.00	B61	-5363201.80
-53529.05	-3653302.00	B62	-5363199.80
-53525.68	-3653300.00	B63	-5363197.80
-53522.31	-3653298.00	B64	-5363195.80
-53518.94	-3653296.00	B65	-5363193.80
-53515.57	-3653294.00	B66	-5363191.80
-53512.20	-3653292.00	B67	-5363189.80
-53508.83	-3653290.00	B68	-5363187.80
-53505.46	-3653288.00	B69	-5363185.80
-53502.09	-3653286.00	B70	-5363183.80
-53498.72	-3653284.00	B71	-5363181.80
-53495.35	-3653282.00	B72	-5363179.80
-53491.98	-3653280.00	B73	-5363177.80
-53488.61	-3653278.00	B74	-5363175.80
-53485.24	-3653276.00	B75	-5363173.80
-53481.87	-3653274.00	B76	-5363171.80
-53478.50	-3653272.00	B77	-5363169.80
-53475.13	-3653270.00	B78	-5363167.80
-53471.76	-3653268.00	B79	-5363165.80
-53468.39	-3653266.00	B80	-5363163.80
-53465.02	-3653264.00	B81	-5363161.80
-53461.65	-3653262.00	B82	-5363159.80
-53458.28	-3653260.00	B83	-5363157.80
-53454.91	-3653258.00	B84	-5363155.80
-53451.54	-3653256.00	B85	-5363153.80
-53448.17	-3653254.00	B86	-5363151.80
-53444.80	-3653252.00	B87	-5363149.80
-53441.43	-3653250.00	B88	-5363147.80
-53438.06	-3653248.00	B89	-5363145.80
-53434.69	-3653246.00	B90	-5363143.80
-53431.32	-3653244.00	B91	-5363141.80
-53427.95	-3653242.00	B92	-5363139.80
-53424.58	-3653240.00	B93	-5363137.80
-53421.21	-3653238.00	B94	-5363135.80
-53417.84	-3653236.00	B95	-5363133.80
-53414.47	-3653234.00	B96	-5363131.80
-53411.10	-3653232.00	B97	-5363129.80
-53407.73	-3653230.00	B98	-5363127.80
-53404.36	-3653228.00	B99	-5363125.80
-53401.00	-3653226.00	B100	-5363123.80

BENCHMARK NAME			
TY	X	Y	TYPE
P202_S1	53475.257	-3654001.162	P1a: Paxon
P202_S2	53475.258	-3654001.162	P1a: Paxon
P202_S3	53475.259	-3653994.385	P1a: Paxon
P202_S4	53475.260	-3654001.162	P1a: Paxon
P202_S5	53475.261	-3654001.162	P1a: Paxon
P202_S6	53475.262	-3654001.162	P1a: Paxon
P202_S7	53475.263	-3654001.162	P1a: Paxon
P202_S8	53475.264	-3654001.162	P1a: Paxon
P202_S9	53475.265	-3654001.162	P1a: Paxon
P202_S10	53475.266	-3654001.162	P1a: Paxon
P202_S11	53475.267	-3654001.162	P1a: Paxon
P202_S12	53475.268	-3654001.162	P1a: Paxon
P202_S13	53475.269	-3654001.162	P1a: Paxon
P202_S14	53475.270	-3654001.162	P1a: Paxon
P202_S15	53475.271	-3654001.162	P1a: Paxon
P202_S16	53475.272	-3654001.162	P1a: Paxon
P202_S17	53475.273	-3654001.162	P1a: Paxon
P202_S18	53475.274	-3654001.162	P1a: Paxon
P202_S19	53475.275	-3654001.162	P1a: Paxon
P202_S20	53475.276	-3654001.162	P1a: Paxon
P202_S21	53475.277	-3654001.162	P1a: Paxon
P202_S22	53475.278	-3654001.162	P1a: Paxon
P202_S23	53475.279	-3654001.162	P1a: Paxon
P202_S24	53475.280	-3654001.162	P1a: Paxon
P202_S25	53475.281	-3654001.162	P1a: Paxon
P202_S26	53475.282	-3654001.162	P1a: Paxon
P202_S27	53475.283	-3654001.162	P1a: Paxon
P202_S28	53475.284	-3654001.162	P1a: Paxon
P202_S29	53475.285	-3654001.162	P1a: Paxon
P202_S30	53475.286	-3654001.162	P1a: Paxon
P202_S31	53475.287	-3654001.162	P1a: Paxon
P202_S32	53475.288	-3654001.162	P1a: Paxon
P202_S33	53475.289	-3654001.162	P1a: Paxon
P202_S34	53475.290	-3654001.162	P1a: Paxon
P202_S35	53475.291	-3654001.162	P1a: Paxon
P202_S36	53475.292	-3654001.162	P1a: Paxon
P202_S37	53475.293	-3654001.162	P1a: Paxon
P202_S38	53475.294	-3654001.162	P1a: Paxon
P202_S39	53475.295	-3654001.162	P1a: Paxon
P202_S40	53475.296	-3654001.162	P1a: Paxon
P202_S41	53475.297	-3654001.162	P1a: Paxon
P202_S42	53475.298	-3654001.162	P1a: Paxon
P202_S43	53475.299	-3654001.162	P1a: Paxon
P202_S44	53475.300	-3654001.162	P1a: Paxon
P202_S45	53475.301	-3654001.162	P1a: Paxon
P202_S46	53475.302	-3654001.162	P1a: Paxon
P202_S47	53475.303	-3654001.162	P1a: Paxon
P202_S48	53475.304	-3654001.162	P1a: Paxon
P202_S49	53475.305	-3654001.162	P1a: Paxon
P202_S50	53475.306	-3654001.162	P1a: Paxon
P202_S51	53475.307	-3654001.162	P1a: Paxon
P202_S52	53475.308	-3654001.162	P1a: Paxon
P202_S53	53475.309	-3654001.162	P1a: Paxon
P202_S54	53475.310	-3654001.162	P1a: Paxon
P202_S55	53475.311	-3654001.162	P1a: Paxon
P202_S56	53475.312	-3654001.162	P1a: Paxon
P202_S57	53475.313	-3654001.162	P1a: Paxon
P202_S58	53475.314	-3654001.162	P1a: Paxon
P202_S59	53475.315	-3654001.162	P1a: Paxon
P202_S60	53475.316	-3654001.162	P1a: Paxon
P202_S61	53475.317	-3654001.162	P1a: Paxon
P202_S62	53475.318	-3654001.162	P1a: Paxon
P202_S63	53475.319	-3654001.162	P1a: Paxon
P202_S64	53475.320	-3654001.162	P1a: Paxon
P202_S65	53475.321	-3654001.162	P1a: Paxon
P202_S66	53475.322	-3654001.162	P1a: Paxon
P202_S67	53475.323	-3654001.162	P1a: Paxon
P202_S68	53475.324	-3654001.162	P1a: Paxon
P202_S69	53475.325	-3654001.162	P1a: Paxon
P202_S70	53475.326	-3654001.162	P1a: Paxon
P202_S71	53475.327	-3654001.162	P1a: Paxon
P202_S72	53475.328	-3654001.162	P1a: Paxon
P202_S73	53475.329	-3654001.162	P1a: Paxon
P202_S74	53475.330	-3654001.162	P1a: Paxon
P202_S75	53475.331	-3654001.162	P1a: Paxon
P202_S76	53475.332	-3654001.162	P1a: Paxon
P202_S77	53475.333	-3654001.162	P1a: Paxon
P202_S78	53475.334	-3654001.162	P1a: Paxon
P202_S79	53475.335	-3654001.162	P1a: Paxon
P202_S80	53475.336	-3654001.162	P1a: Paxon
P202_S81	53475.337	-3654001.162	P1a: Paxon
P202_S82	53475.338	-3654001.162	P1a: Paxon
P202_S83	53475.339	-3654001.162	P1a: Paxon
P202_S84	53475.340	-3654001.162	P1a: Paxon
P202_S85	53475.341	-3654001.162	P1a: Paxon
P202_S86	53475.342	-3654001.162	P1a: Paxon
P202_S87	53475.343	-3654001.162	P1a: Paxon
P202_S88	53475.344	-3654001.162	P1a: Paxon
P202_S89	53475.345	-3654001.162	P1a: Paxon
P202_S90	53475.346	-3654001.162	P1a: Paxon
P202_S91	53475.347	-3654001.162	P1a: Paxon
P202_S92	53475.348	-3654001.162	P1a: Paxon
P202_S93	53475.349	-3654001.162	P1a: Paxon
P202_S94	53475.350	-3654001.162	P1a: Paxon
P202_S95	53475.351	-3654001.162	P1a: Paxon
P202_S96	53475.352	-3654001.162	P1a: Paxon
P202_S97	53475.353	-3654001.162	P1a: Paxon
P202_S98	53475.354	-3654001.162	P1a: Paxon
P202_S99	53475.355	-3654001.162	P1a: Paxon
P202_S100	53475.356	-3654001.162	P1a: Paxon
P202_S101	53475.357	-3654001.162	P1a: Paxon
P202_S102	53475.358	-3654001.162	P1a: Paxon
P202_S103	53475.359	-3654001.162	P1a: Paxon
P202_S104	53475.360	-3654001.162	P1a: Paxon
P202_S105	53475.361	-3654001.162	P1a: Paxon
P202_S106	53475.362	-3654001.162	P1a: Paxon
P202_S107	53475.363	-3654001.162	P1a: Paxon
P202_S108	53475.364	-3654001.162	P1a: Paxon
P202_S109	53475.365	-3654001.162	P1a: Paxon
P202_S110	53475.366	-3654001.162	P1a: Paxon
P202_S111	53475.367	-3654001.162	P1a: Paxon
P202_S112	53475.368	-3654001.162	P1a: Paxon
P202_S113	53475.369	-3654001.162	P1a: Paxon
P202_S114	53475.370	-3654001.162	P1a: Paxon
P202_S115	53475.371	-3654001.162	P1a: Paxon
P202_S116	53475.372	-3654001.162	P1a: Paxon
P202_S117	53475.373	-3654001.162	P1a: Paxon
P202_S118	53475.374	-3654001.162	P1a: Paxon
P202_S119	53475.375	-3654001.162	P1a: Paxon
P202_S120	53475.376	-3654001.162	P1a: Paxon
P202_S121	53475.377	-3654001.162	P1a: Paxon
P202_S122	53475.378	-3654001.162	P1a: Paxon
P202_S123	53475.379	-3654001.162	P1a: Paxon
P202_S124	53475.380	-3654001.162	P1a: Paxon
P202_S125	53475.381	-3654001.162	P1a: Paxon
P202_S126	53475.382	-3654001.162	P1a: Paxon
P202_S127	53475.383	-3654001.162	P1a: Paxon
P202_S128	53475.384	-3654001.162	P1a: Paxon
P202_S129	53475.385	-3654001.162	P1a: Paxon
P202_S130	53475.386	-3654001.162	P1a: Paxon
P202_S131	53475.387	-3654001.162	P1a: Paxon
P202_S132	53475.388	-3654001.162	P1a: Paxon
P202_S133	53475.389	-3654001.162	P1a: Paxon
P202_S134	53475.390	-3654001.162	P1a: Paxon
P202_S135	53475.391	-3654001.162	P1a: Paxon
P202_S136	53475.392	-3654001.162	P1a: Paxon
P202_S137	53475.393	-3654001.162	P1a: Paxon
P202_S138	53475.394	-3654001.162	P1a: Paxon
P202_S139	53475.395	-3654001.162	P1a: Paxon
P202_S140	53475.396	-3654001.162	P1a: Paxon
P202_S141	53475.397	-3654001.162	P1a: Paxon
P202_S142	53475.398	-3654001.162	P1a: Paxon
P202_S143	53475.399	-3654001.162	P1a: Paxon
P202_S144	53475.400	-3654001.162	P1a: Paxon
P202_S145	53475.401	-3654001.162	P1a: Paxon
P202_S146	53475.402	-3654001.162	P1a: Paxon
P202_S147	53475.403	-3654001.162	P1a: Paxon
P202_S148	53475.404	-3654001.162	P1a: Paxon
P202_S149	53475.405	-3654001.162	P1a: Paxon
P202_S150	53475.406	-3654001.162	P1a: Paxon
P202_S151	53475.407	-3654001.162	P1a: Paxon
P202_S152	53475.408	-3654001.162	P1a: Paxon
P202_S153	53475.409	-3654001.162	P1a: Paxon
P202_S154	53475.410	-3654001.162	P1a: Paxon
P202_S155	53475.411	-3654001.162	P1a: Paxon
P202_S156	53475.412	-3654001.162	P1a: Paxon
P202_S157	53475.413	-3654001.162	P1a: Paxon
P202_S158	53475.414	-3654001.162	P1a: Paxon
P202_S159	53475.415	-3654001.162	P1a: Paxon
P202_S160	53475.416	-3654001.162	P1a: Paxon
P202_S161	53475.417	-3654001.162	P1a: Paxon
P202_S162	53475.418	-3654001.162	P1a: Paxon
P202_S163	53475.419	-3654001.162	P1a: Paxon
P202_S164	53475.420	-3654001.162	P1a: Paxon
P202_S165	53475.421	-3654001.162	P1a: Paxon
P202_S166	53475.422	-3654001.162	P1a: Paxon
P202_S167	53475.423	-3654001.162	P1a: Paxon
P202_S168	53475.424	-3654001.162	P1a: Paxon
P202_S169	53475.425	-3654001.162	P1a: Paxon
P202_S170	53475.426	-3654001.162	P1a: Paxon
P202_S171	53475.427	-3654001.162	P1a: Paxon
P202_S172	53475.428	-3654001.162	P1a: Paxon
P202_S173	53475.429	-3654001.162	P1a: Paxon
P202_S174	53475.430	-3654001.162	P1a: Paxon
P202_S175	53475.431	-3654001.162	P1a: Paxon
P202_S176	53475.432	-3654001.162	P1a: Paxon
P202_S177	53475.433	-3654001.162	P1a: Paxon
P202_S178	53475.434	-3654001.162	P1a: Paxon
P202_S179	53475.435	-3654001.162	P1a: Paxon
P202_S180	53475.436	-3654001.162	P1a: Paxon
P202_S181	53475.437	-3654001.162	P1a: Paxon
P202_S182	53475.438	-3654001.162	P1a: Paxon
P202_S183	53475.439	-3654001.162	P1a: Paxon
P202_S184	53475.440	-3654001.162	P1a: Paxon
P202_S185	53475.441	-3654001.162	P1a: Paxon
P202_S186	53475.442	-3654001.162	P1a: Paxon
P202_S187	53475.443	-3654001.162	P1a: Paxon
P202_S188	53475.444	-3654001.162	P1a: Paxon
P202_S189	53475.445	-3654001.162	P1a: Paxon
P202_S190	53475.446	-3654001.162	P1a: Paxon
P202_S191	53475.447	-3654001.162	P1a: Paxon
P202_S192	53475.448	-3654001.162	P1a: Paxon
P202_S193	53475.449	-3654001.162	P1a: Paxon
P202_S194	53475.450	-3654001.162	P1a: Paxon
P202_S195	53475.451	-3654001.162	P1a: Paxon
P202_S196	53475.452	-3654001.162	P1a: Paxon
P202_S197	53475.453	-3654001.162	P1a: Paxon
P202_S198	53475.454	-3654001.162	P1a: Paxon
P202_S199	53475.455	-3654001.162	P1a: Paxon
P202_S200	53475.456	-3654001.162	P1a: Paxon
P202_S201	53475.457	-3654001.162	P1a: Paxon
P202_S202	53475.458	-3654001.162	P1a: Paxon
P202_S203	53475.459	-3654001.162	P1a: Paxon
P202_S204	53475.460	-3654001.162	P1a: Paxon
P202_S205	53475.461	-3654001.162	P1a: Paxon
P202_S206	53475.462	-3654001.162	P1a: Paxon
P202_S207	53475.463	-3654001.162	P1a: Paxon
P202_S208	53475.464	-3654001.162	P1a: Paxon
P202_S209	53475.465	-3654001.162	P1a: Paxon
P202_S210	53475.466	-3654001.162	P1a: Paxon
P202_S211	53475.467	-3654001.162	P1a: Paxon
P202_S212	53475.468	-3654001.162	P1a: Paxon
P202_S213	53475.469	-3654001.162	P1a: Paxon
P202_S214	53475.470	-3654001.162	P1a: Paxon
P202_S215	53475.471	-3654001.162	P1a: Paxon
P202_S216	53475.472	-3654001.162	P1a: Paxon
P202_S217	53475.473	-3654001.162	P1a: Paxon
P202_S218	53475.474	-3654001.162	P1a: Paxon
P202_S219	53475.475	-3654001.162	P1a: Paxon
P202_S220	53475.476	-3654001.162	P1a: Paxon
P202_S221	53475.477	-3654001.162	P1a: Paxon
P202_S222	53475.478	-3654001.162	P1a: Paxon
P202_S223			